

DIAGRAM

Scale 1:500 Lengths are in Metres

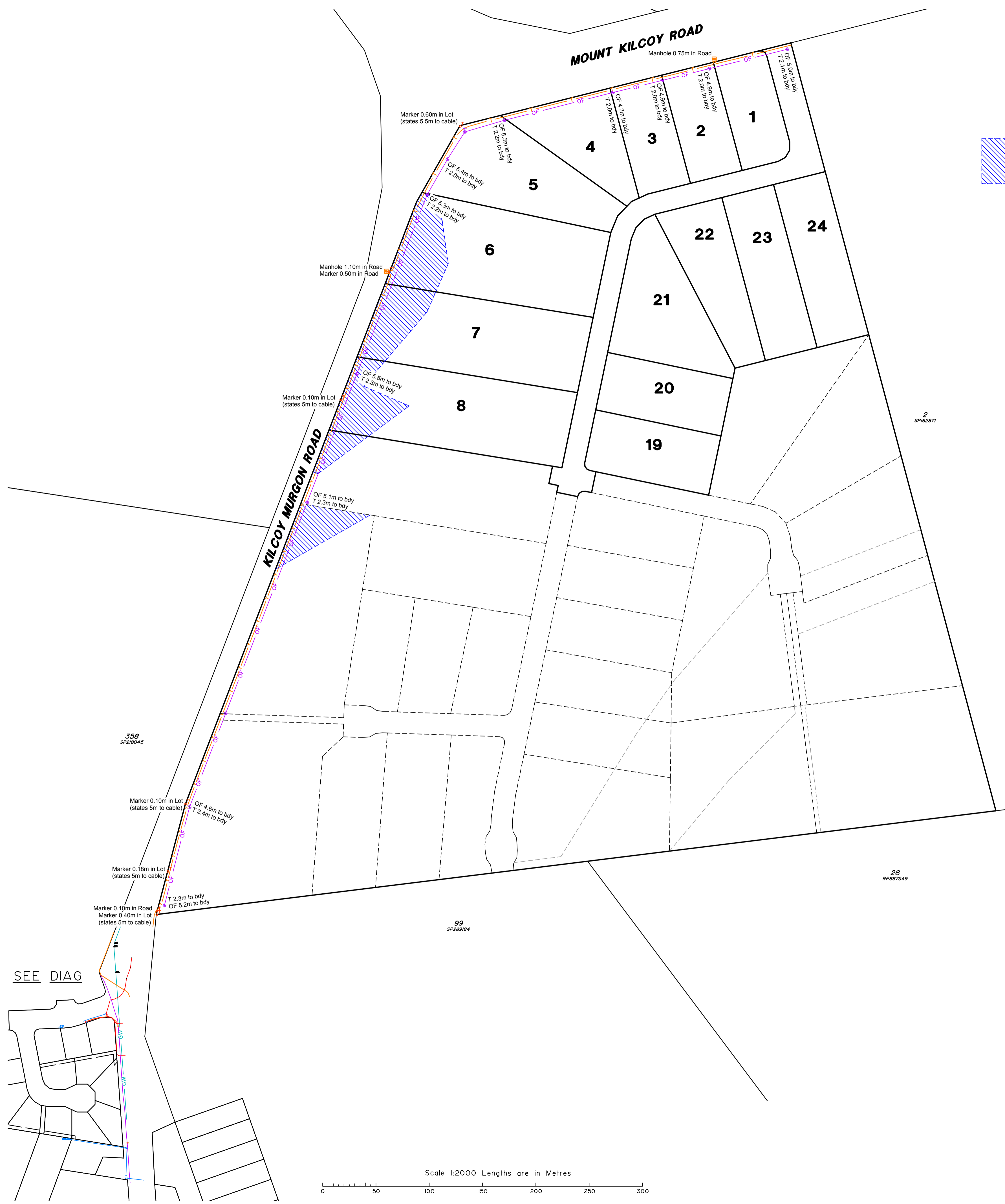
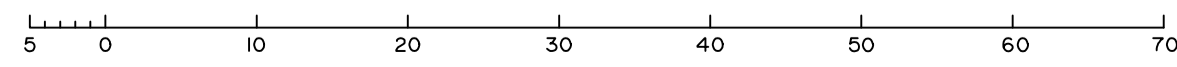

PROPOSED DETENTION BASIN

Mount Kilcoy Road
For
Tonlen Pty Ltd

This plan is prepared for Tonlen Pty Ltd from a combination of field survey and existing records for the purpose of preliminary architectural and engineering design and should not be used for any other purpose.

The site boundaries as shown herein have been determined from minimum connections to survey marks placed by others and then from measurements by others. The verification of which does not form part of this survey.

Report has been made only on selected services and features as specified in the scope of works. If not able to be so located, known services have been plotted from the records of relevant authorities where available and have been noted accordingly on this plan. Where such records either do not exist or are considered inadequate, a notation has been made hereon.

The Position of underground services on this drawing are indicated by a single line. Care should be exercised as services may occupy a considerably wider corridor than that indicated on this drawing. Users should be aware during excavation or construction that services may exist for which there is no record.

Prior to any demolition, excavation or construction on the site, the relevant authority should be contacted for possible location of further underground services and detailed location of all services.

LIDAR and LIDAR data has been utilised to supplement areas that were not physically surveyed. Differences may occur of +150mm in height where LIDAR applies and +300mm where LIDAR applies, however this may be higher or lower at any given location. Care should be taken when utilising these datasets and physical survey should be completed in areas of interest.

© The State of Queensland (Department of Natural Resources, Mines and Energy) (21/05/2019).
Based on or contains data provided by the State of Queensland (Department of Natural Resources, Mines and Energy) (21/05/2019). In consideration of the State permitting use of this data you acknowledge and agree that the State gives no warranty in relation to the data (including accuracy, reliability, completeness, currency or suitability) and accepts no liability (including without limitation, liability in negligence) for any loss, damage or costs (including consequential damage) resulting from any use of the data. Data must not be used for direct marketing or be used in breach of the privacy laws.

In particular, no reliance should be placed on the information on this plan for any financial dealings involving the land.

Copyright © Vers Australia Pty Ltd. 12.01.2021

THESE DESIGNS AND DRAWINGS ARE COPYRIGHT AND ARE NOT TO BE USED OR REPRODUCED WITHOUT THE WRITTEN PERMISSION OF VERS

Data Sources	
Cadastral Boundaries	425162 Surround and Control.126
Contours / Topographic	425162 Detail Survey.126
Aerial Images	425162 Mount Kilcoy Road.244

Issue	Revisions	Date	Drawn
A	Original	12.01.2021	EH

Locality: Winya
Local Authority: Somerset Regional
Projection: GDA84
Horizontal Meridian: MGA Zone 56
Vertical Level Datum: AHD
Level Origin: PM40561 RL:116.668
Scale: 1:2000 @ A1
Surveyed: RH 21.12.2020
Designed: *
Drawn: EH 12.01.2021
Checked: AB 12.01.2021
Plot Date: 12 Jan, 2021
Computer File Ref: 425162-GE01-A.dwg

Detail Plan showing location of Telstra & Water



BRISBANE (07) 3666 4700 WHITSUNDAYS (07) 4945 6600
MACKAY (07) 4957 9700 CAIRNS (07) 4032 9400
veris.com.au
ACN 615 735 727
Veris Australia Pty Ltd