

**LEGEND**

- PROPOSED EASEMENT (1% AEP)
- PROPOSED DRIVEWAY LOCATION  
DRIVEWAY TO BE 2 COAT SEAL UP TO PROPERTY BOUNDARY, FULL DRIVEWAY WIDTH
- DEVELOPMENT BOUNDARY
- PROPOSED PILLAR
- PROPOSED STREET LIGHT
- EXISTING TELSTRA
- EXISTING ELECTRICAL
- EXISTING RAW WATER
- EXISTING OPTIC FIBRE
- ROAD EDGE GUIDE POST

**NOTE**

- REFER PROJECT DRAWING 241 FOR NOTES AND SETOUT TABLES.
- ALL SIGN LOCATIONS TO BE CONFIRMED WITH THE SUPERINTENDENT PRIOR TO INSTALLATION.

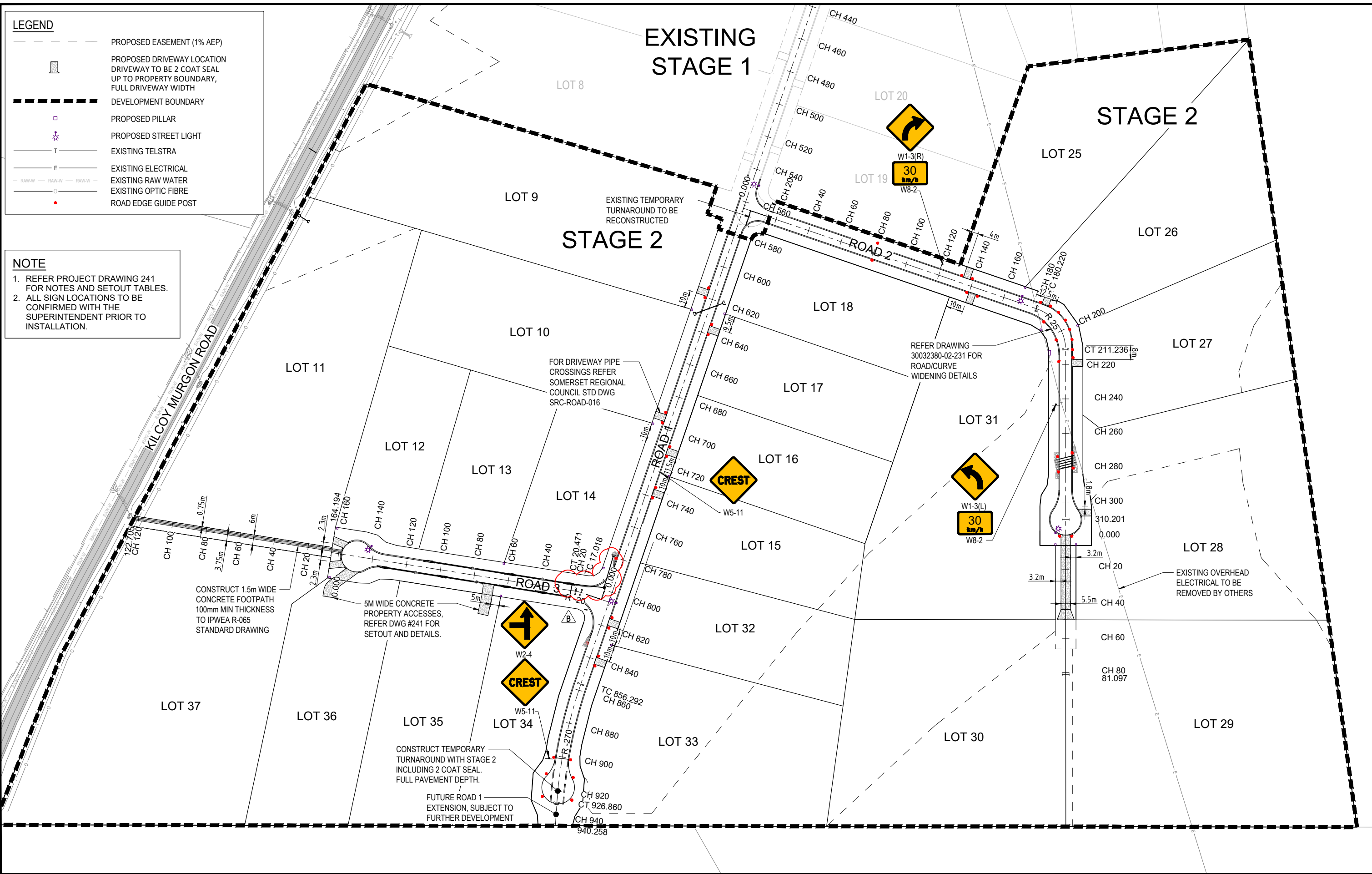

REVISION	DATE	DES/OFT	WVR	APPD
B	31/05/21	SM/JP		CG
A	30/04/21	SM/JP		CG

**CABALLO**  
PARK ESTATE  
- KILCOY -

Principal  
LENNIUM GROUP  
Suite 12/2 Quamby Place  
Noosa Heads QLD 4568

All setting out should be carried out in accordance with GAA/Council's standard drawings or as nominated on hard copy plans provided by SMEC. Any digital information supplied by this office is for information only. Any discrepancies should be discussed with the superintendent.

Project Leader  
C.Green  
Designed  
S.Mango  
Drawn  
J.Price  
Checked  
S.McGill  
Authorised  
C.Green  
Date

Chris Green  
RPEQ 8777

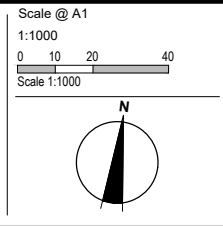

© SMEC Australia Pty Ltd  
ABN 47 065 475 149

These designs and drawings are the copyright of SMEC Australia Pty Ltd. The drawing shall not be reproduced or copied, in whole or part, without the written permission of SMEC Australia Pty Ltd. The contents of this drawing are electronically generated, are confidential and may only be used for the purpose for which they are intended.

**SMEC**  
Member of the UrbanaJung Group  
© ABN 47 065 475 149

**SMEC AUSTRALIA**  
Level 1, 832 Southport-Nerang Road, Nerang, QLD, 4211  
p +61 7 5578 0200 | f +61 7 3029 6650 | www.smec.com

Adelaide +61 8 8225 9800	Brisbane +61 7 3531 9888	Melbourne +61 3 9869 0800
Campbelltown +61 2 4640 8222	Perth +61 8 9323 5900	Traralgon +61 3 5173 0100
Canberra +61 2 6126 1900		

**Caballo Park Estate**  
Mt Kilcoy Road, Winya  
Somerset Regional Council  
Civil Works - Detail Design - Stage 2  
Roadworks Layout Plan  
Drawing No. 30032380-02-201  
Dev. App. No.  
Sheet No. 1 of 1

Rev B  
Issue for Construction